 1=0.84m 2=0.84m 3=1.5m

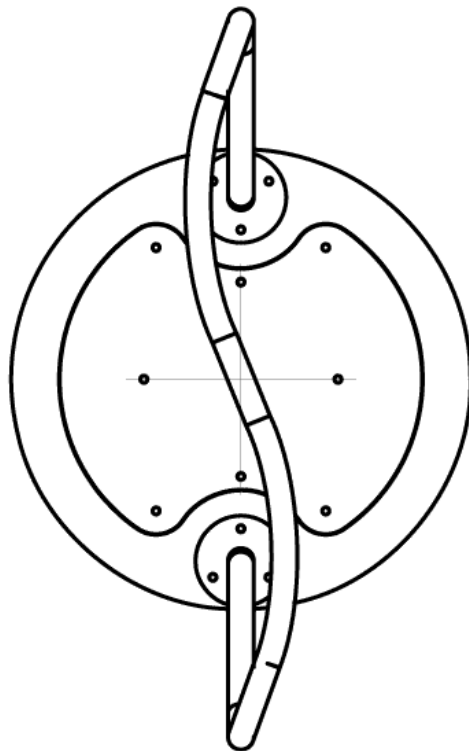

STIMULATION MUSCULAIRE

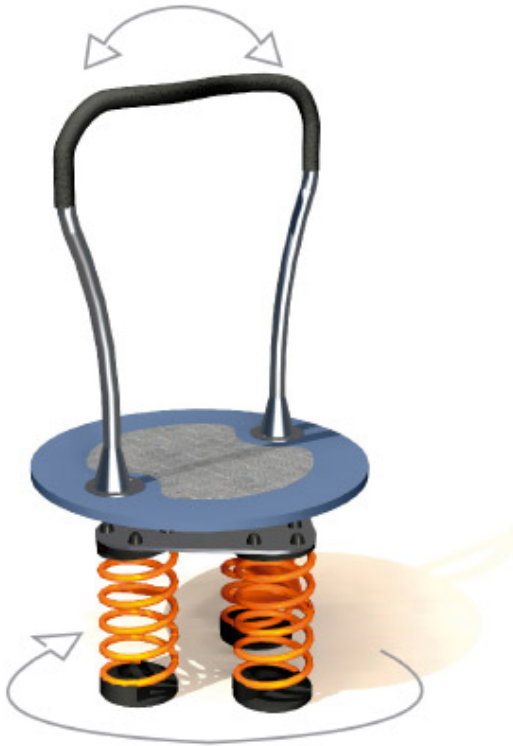

INTENSITE DE L'EFFORT

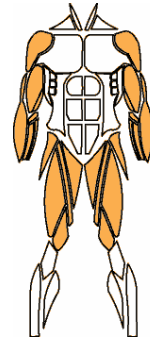

DEPENSE ENERGETIQUE

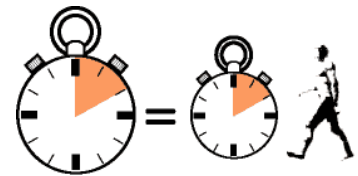

DIMENSIONS & MOUVEMENTS

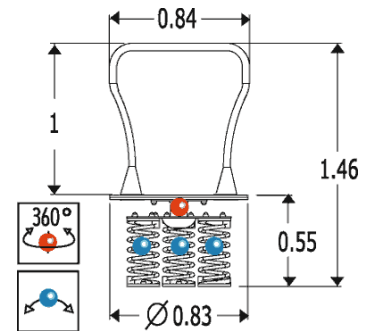

INFOS DIVERSES



4 joueurs

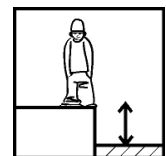

HCL= 0.55m

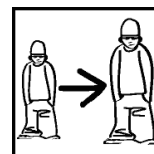

8+

Installation de l'équipement

Zone d'impact : Surface de sol minimale requise

 Zone d'impact

 Espace libre

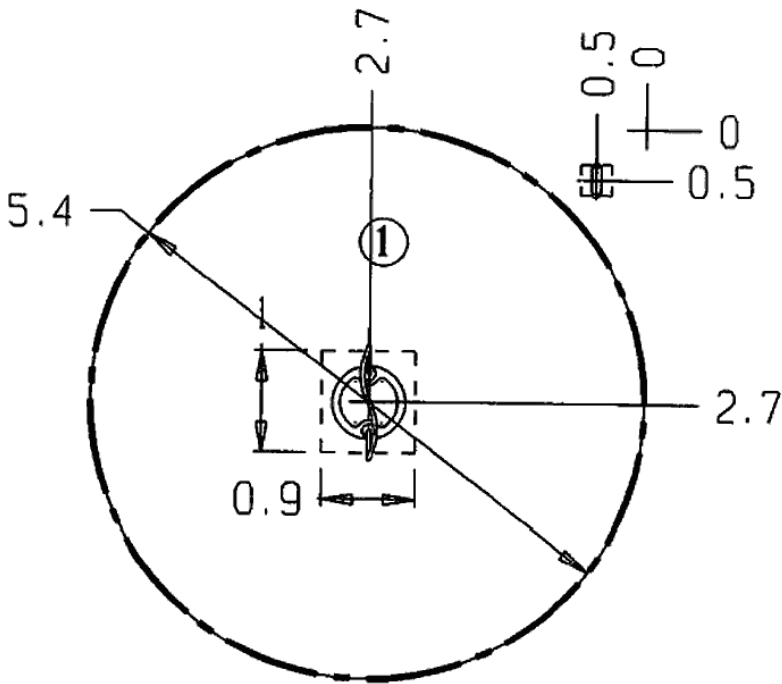

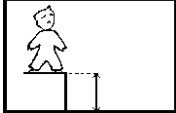
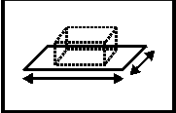
		
①	0,55m	23m ²

INSTALLATION



2

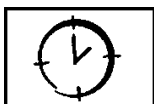

01h00

CERTIFICATIONS

